

A ARCHITECTURE FOR DOGS

No dog, no Life!

designer **SOU FUJIMOTO**
architecture for **BOSTON TERRIER**

update 2012/11/15

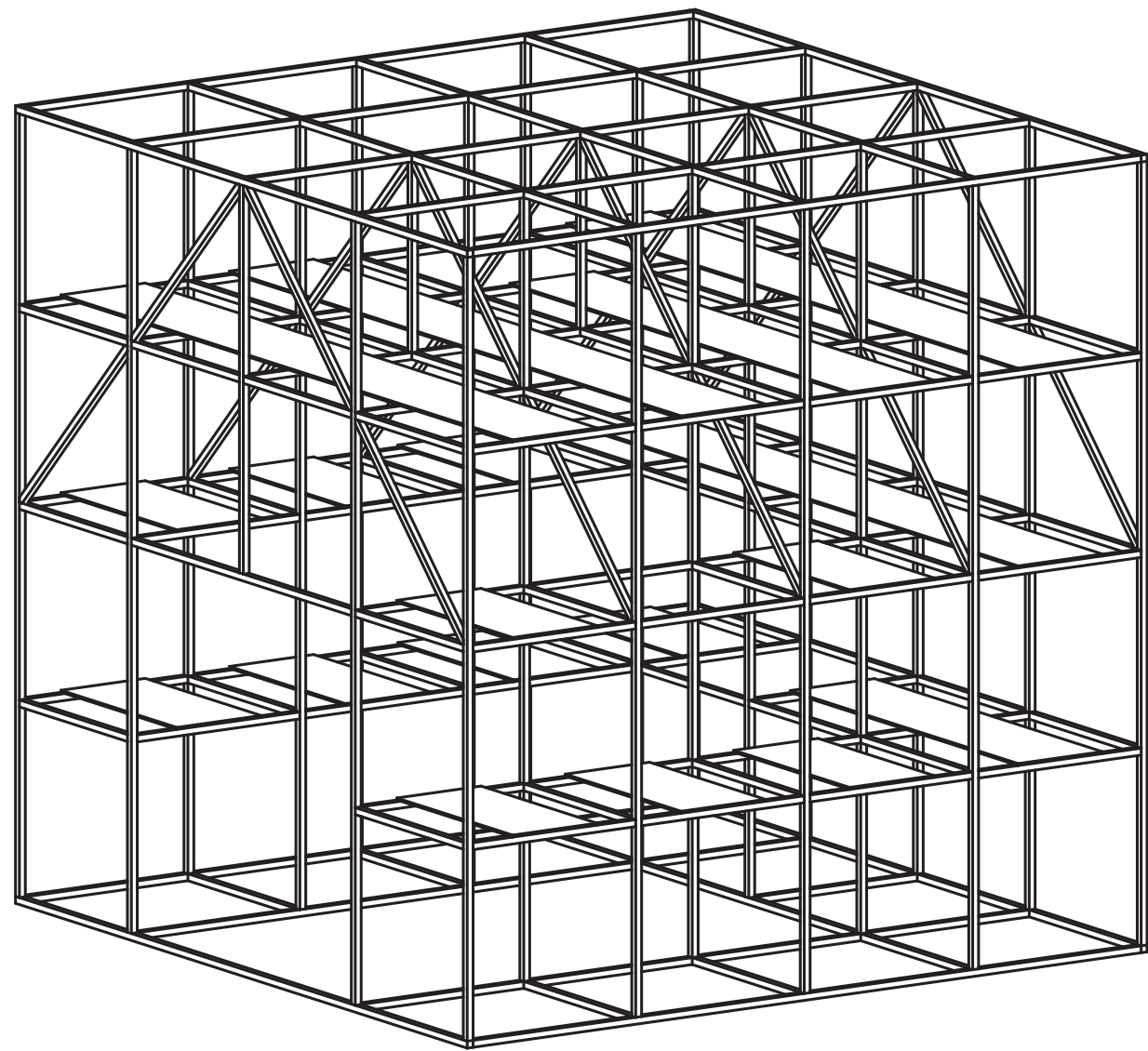

Component Pieces :

scale = 1 : 10

Frame

Cypress 7mm squared • L900mm

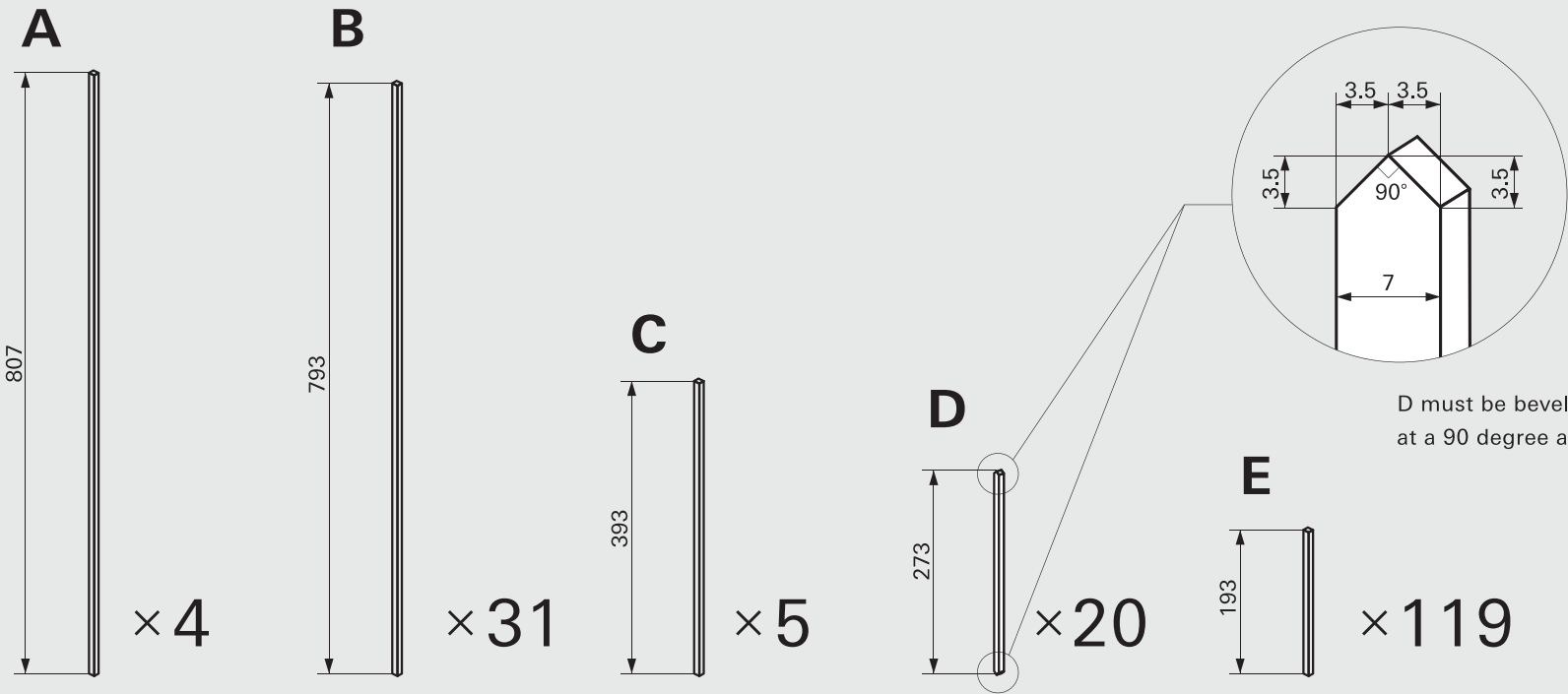

Shelves

Acrylic sheets t=2mm

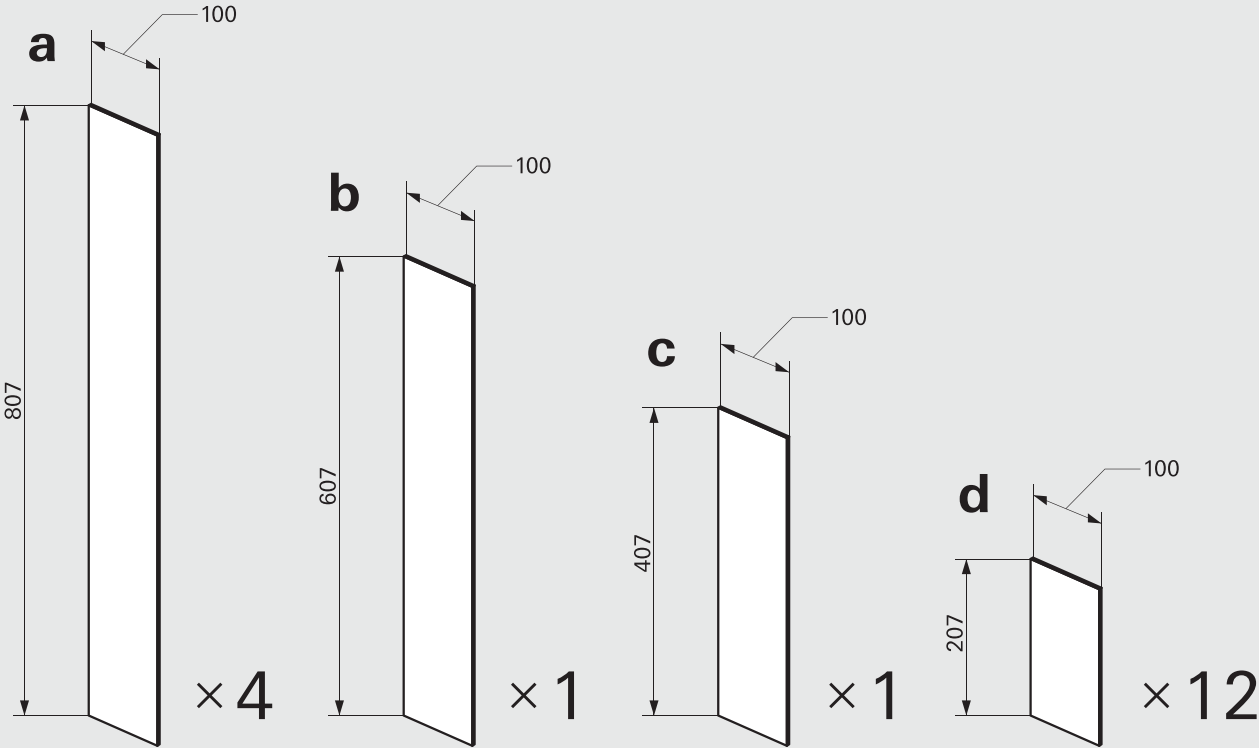

Materials :

- Cypress 7mm squared / L900mm 73 pieces
- Acrylic Sheets / t=2mm
- Wood Glue
- Pin Tacks or Thin Nails
- Varnish or Clear Coat
- Transparent Double-sided Tape

Tools :

- Saw
- Ruler
- Pin Tacks
- Paintbrush

Size :

w800 × d800 × h800 mm

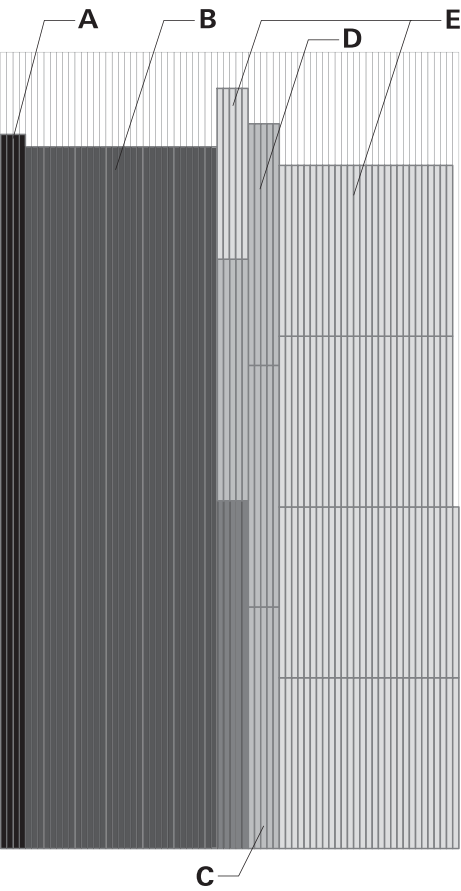

7mm squared / L900mm × 74

This is a construction project and is not advisable for children under the age of 13, unless under the supervision of adults. Please use caution when using cutting tools, and wear eye and hand protection at all times. All measurements are in metric units and our list of wood materials, only suggestions.

Architecture for Dogs is not responsible for any injuries incurred from the building process or derived from the structure itself, nor does it take responsibility for faulty materials or unsatisfactory results.

(c) Architecture for Dogs, 2012. All Rights reserved.
The download of this blueprint in no way transfers any copyright or other ownership interest in them to the buyer except for a limited license to use it to construct one piece at a time.

Assembly Instructions :

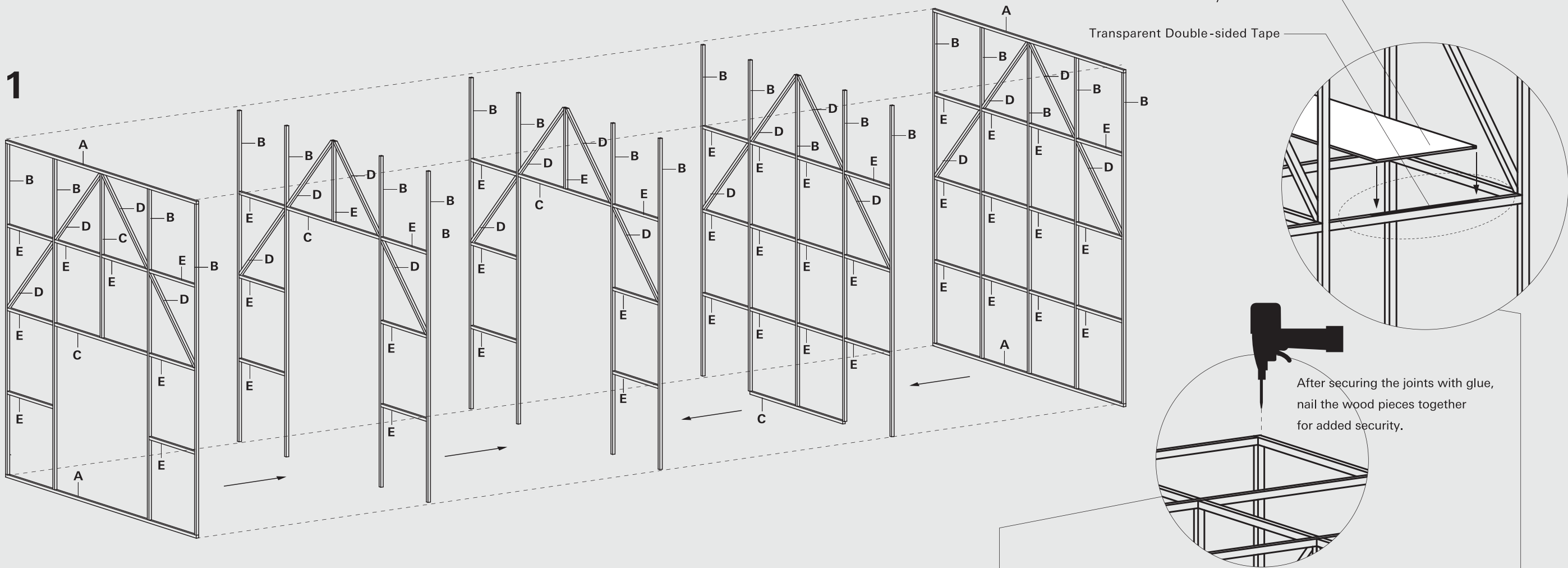

2 B × 9

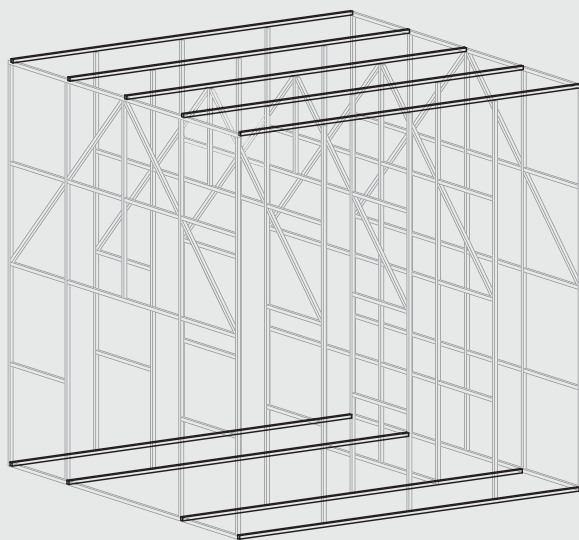

3 E × 55

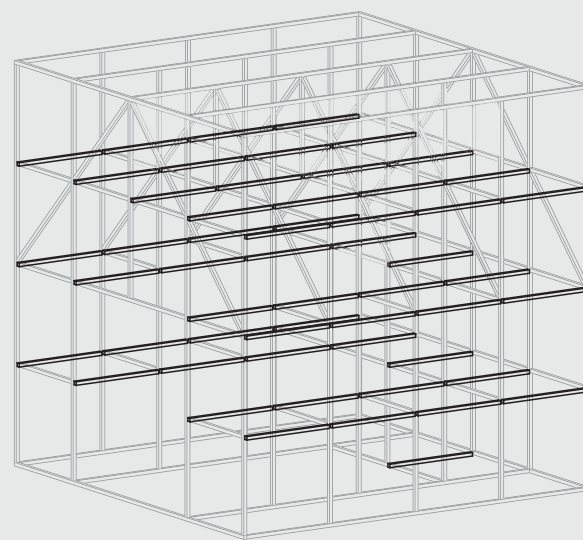

4 E × 18

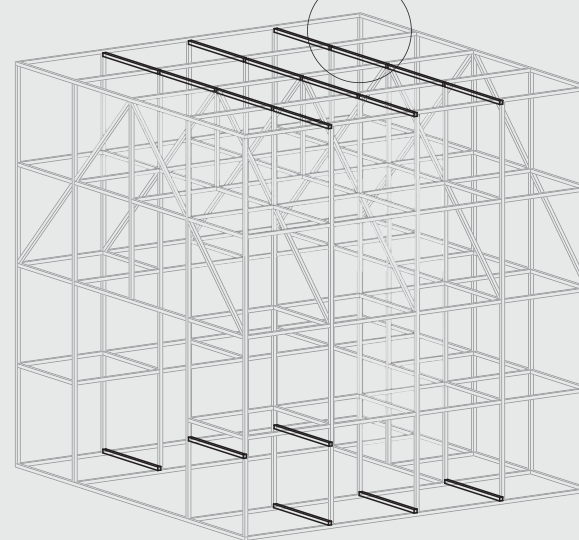

5 a/b/c/d

