

A ARCHITECTURE FOR DOGS

D-Tunnel

designer **KENYA HARA**

architecture for **TEACUP POODLE**

update 2012/11/15

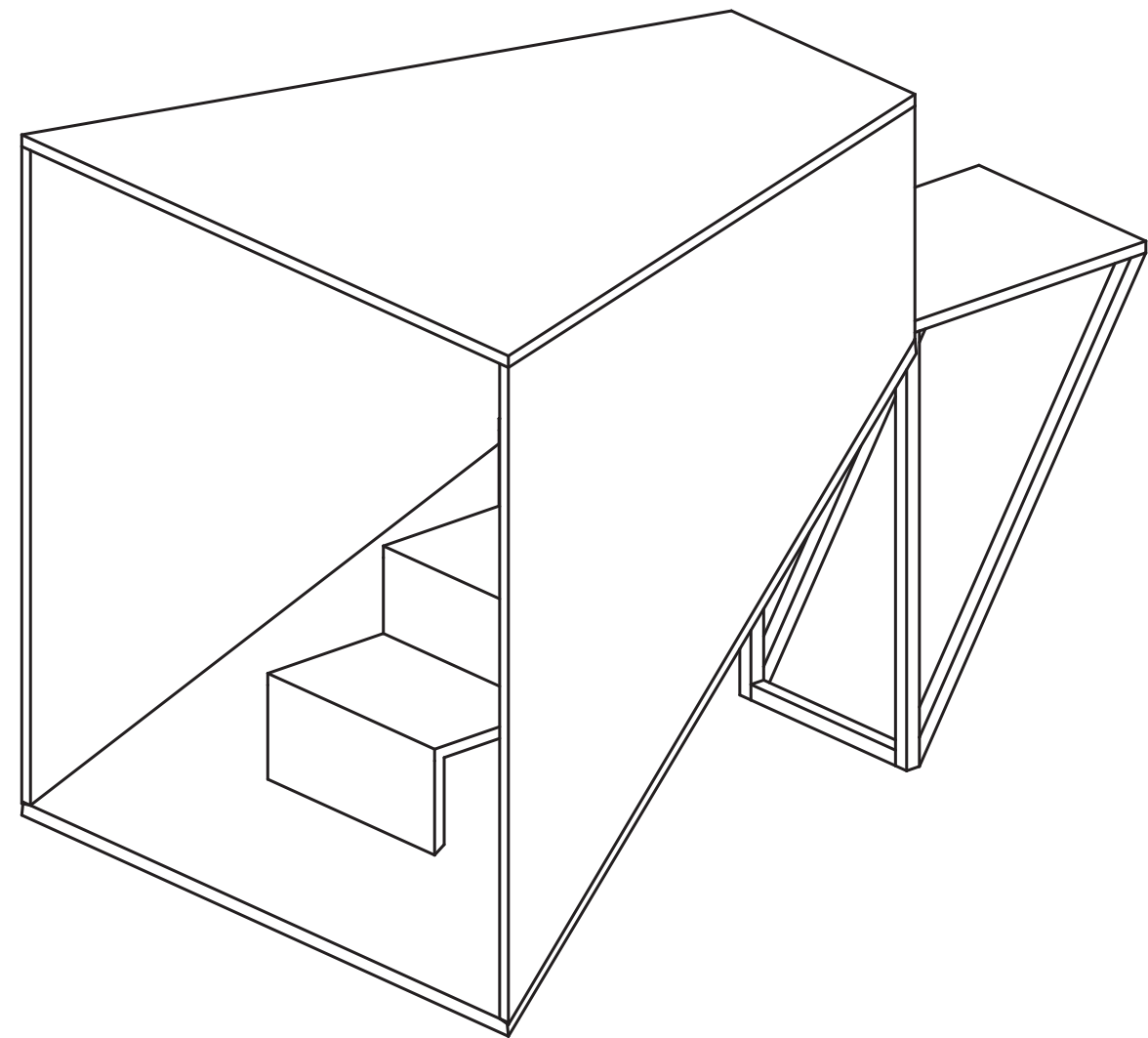

Component Pieces :

scale = 1 : 10

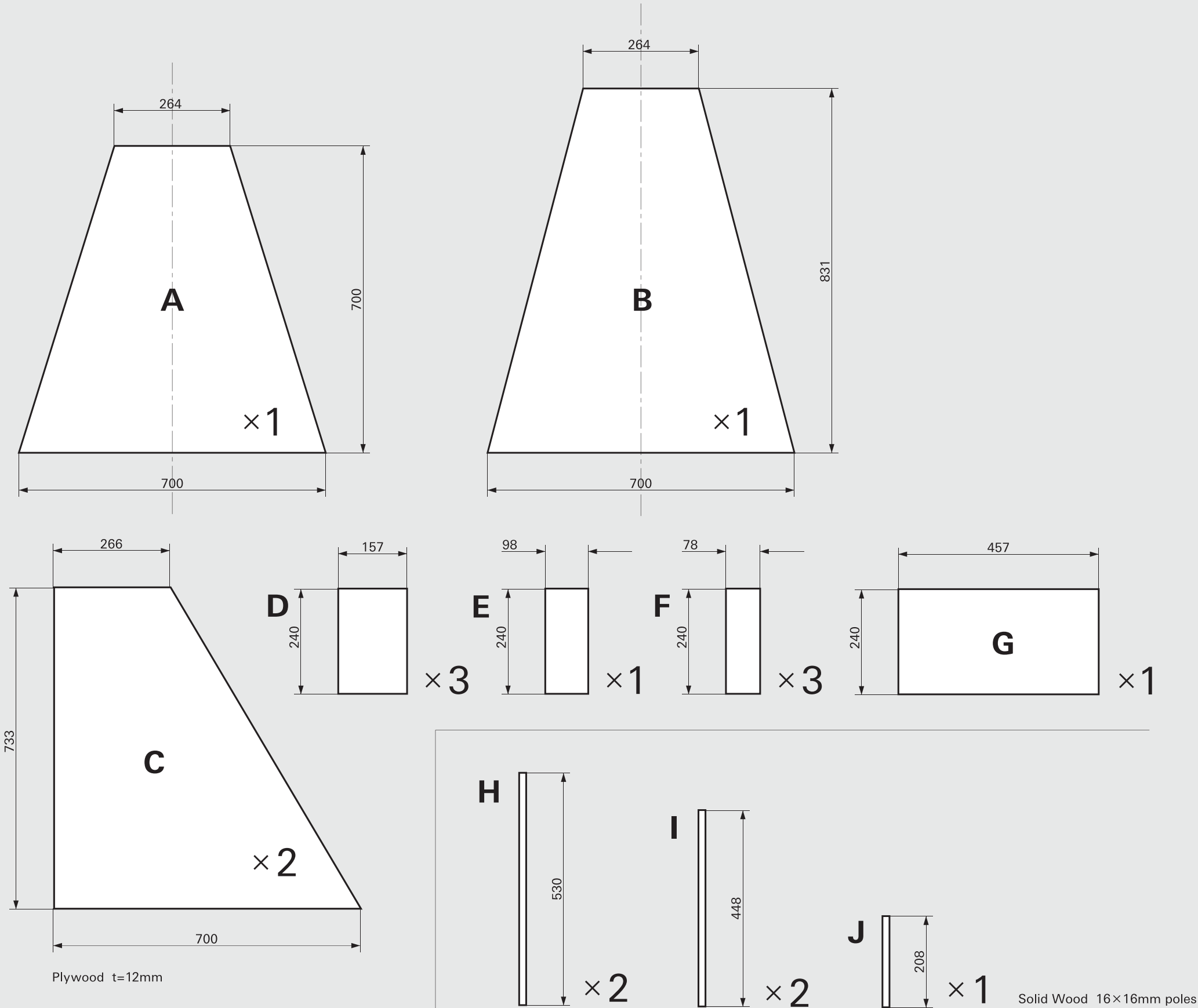

Materials :

- Plywood / w1800×d900mm•t=12mm 2 sheets
- Solid Wood 16mm squared / L900mm 3 pieces
- Varnish or Clear Coat
- Wood Screws
- Glue

Tools :

- Hand Saw or Electric Saw
- File
- Paintbrush
- Bucket
- Drill

Size :

w700 × d1000 × h700 mm

Weight :

Approx. 4 kg

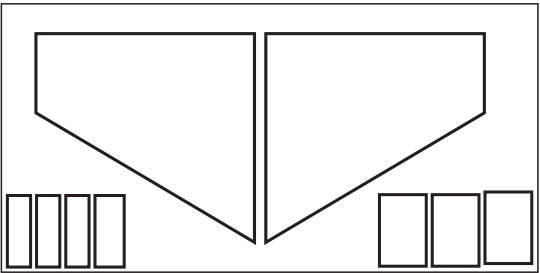
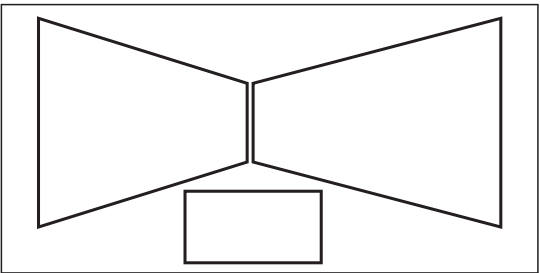

Plywood / w1800 × h900mm•t=12mm ×2



Solid wood 16mm squared / L900mm ×3

This is a construction project and is not advisable for children under the age of 13, unless under the supervision of adults. Please use caution when using cutting tools, and wear eye and hand protection at all times. All measurements are in metric units and our list of wood materials, only suggestions.

Architecture for Dogs is not responsible for any injuries incurred from the building process or derived from the structure itself, nor does it take responsibility for faulty materials or unsatisfactory results.

(c) Architecture for Dogs, 2012. All Rights reserved.
The download of this blueprint in no way transfers any copyright or other ownership interest in them to the buyer except for a limited license to use it to construct one piece at a time.

Assembly Instructions :

1

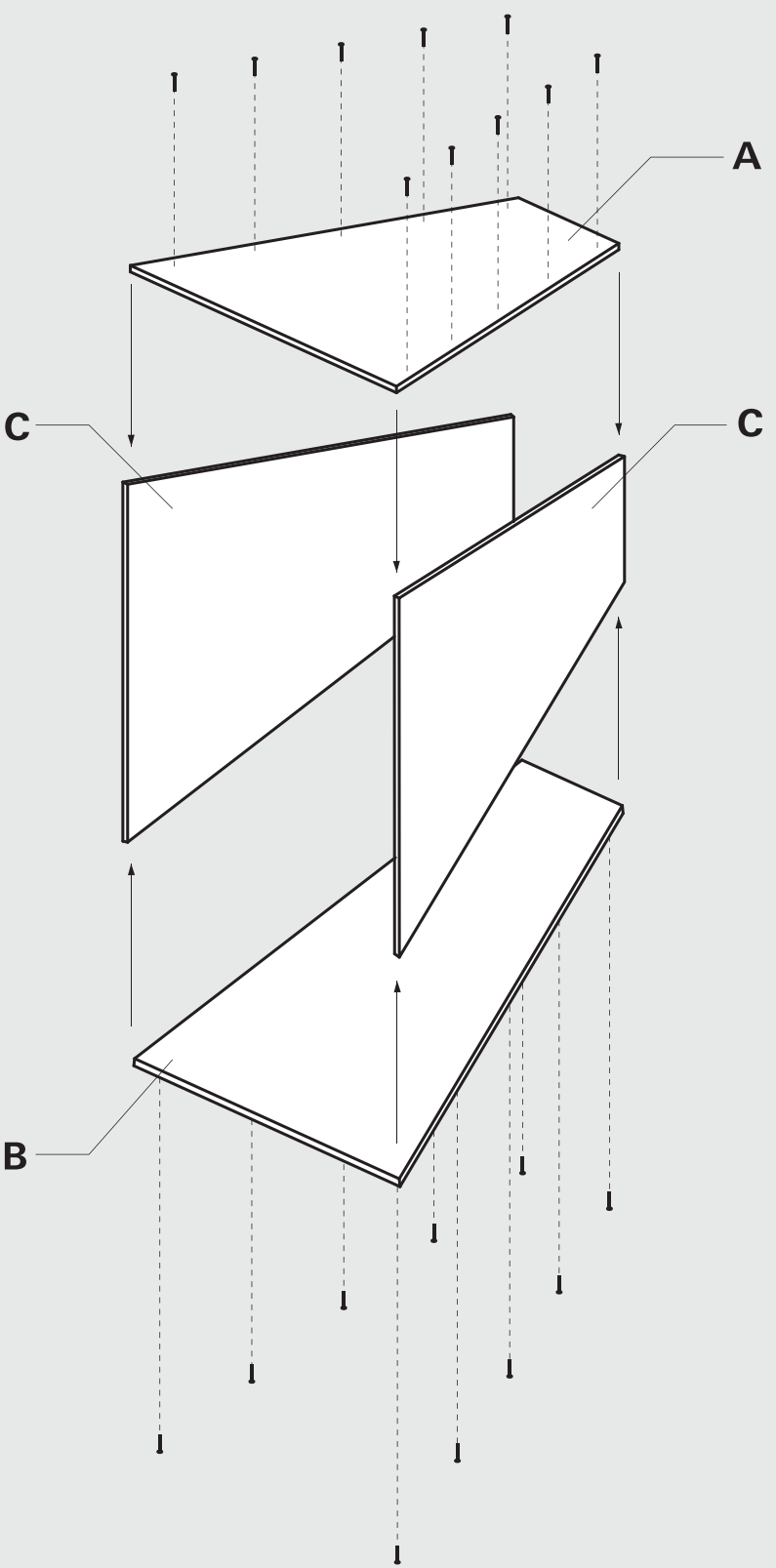

2

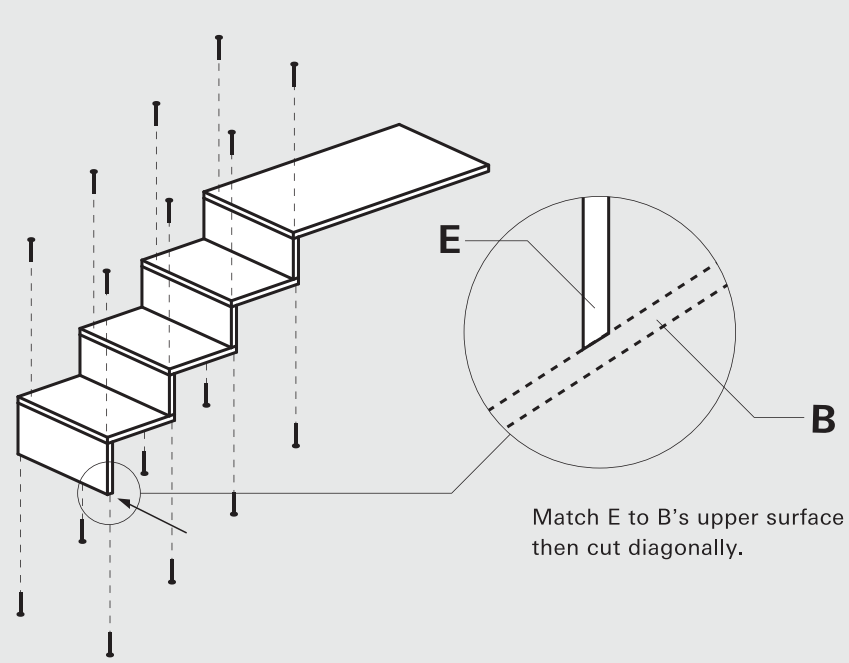

3

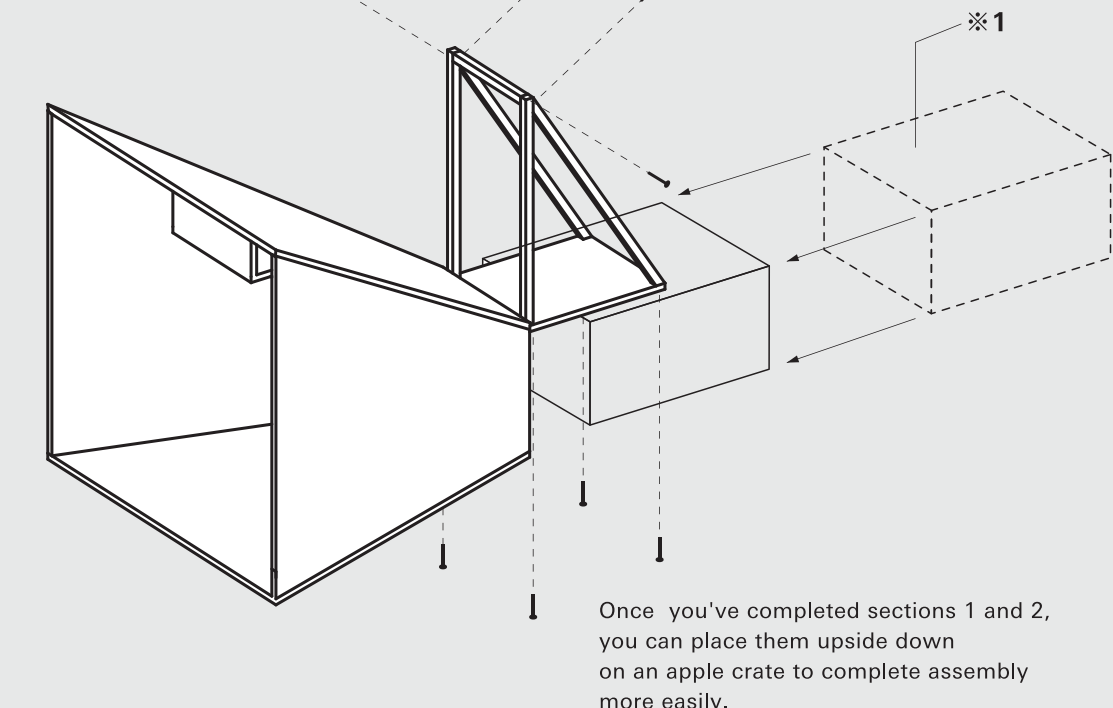

4

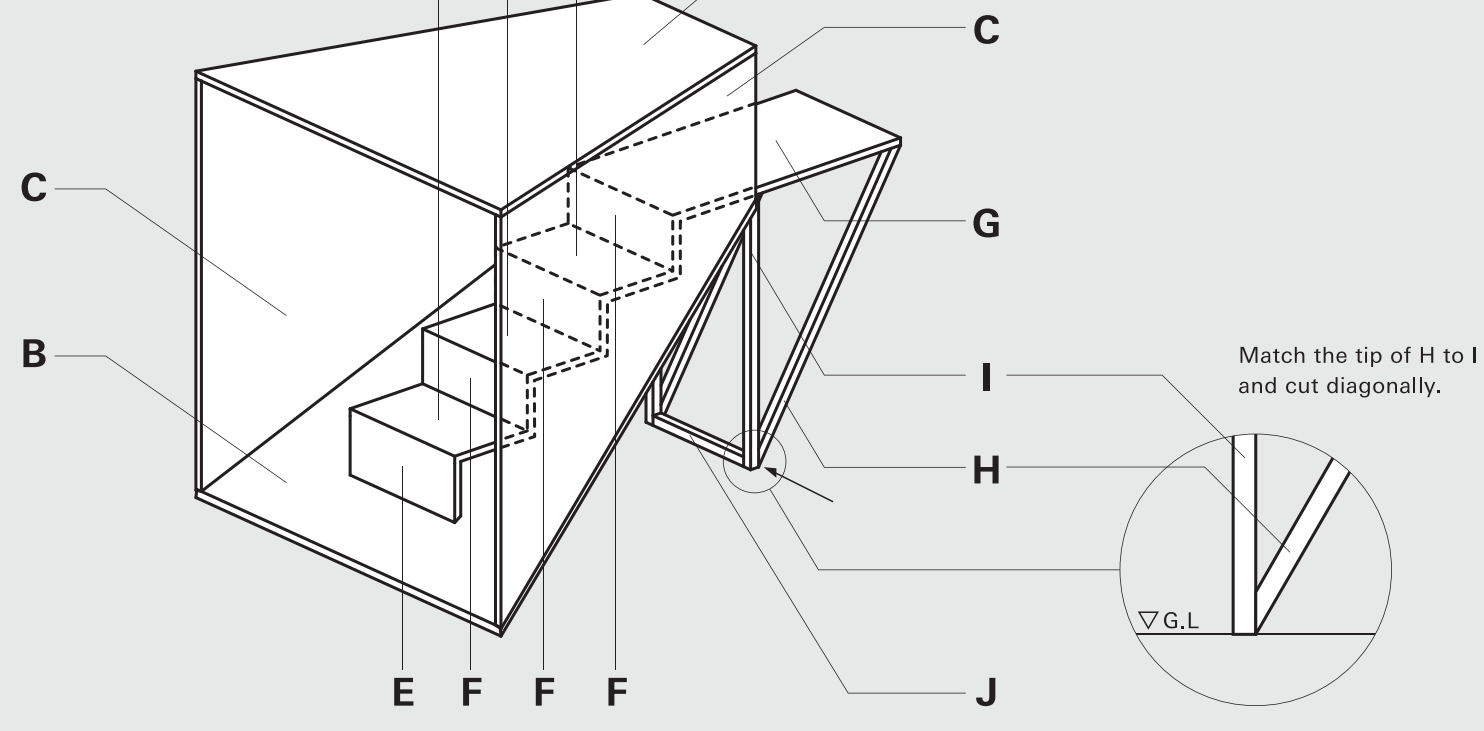

section 1

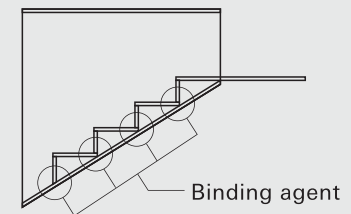

section 2

