

NO DOG, NO LIFE!

Sou FUJIMOTO

藤本壮介



BOSTON TERRIER

ボストンテリア



Born in Hokkaido in 1971. Having graduated from the Tokyo University, he established Sou Fujimoto Architects in 2000. “Serpentine Gallery Summer Pavilion 2013” is his latest work. In 2012, the Japan Pavilion in La Biennale di Venezia, in which Sou also participated, was awarded the Golden Lion.

1971年北海道生まれ。東京大学工学部建築学科卒業。2000年藤本壮介建築設計事務所設立。2013年ロンドンの「サーペントイン・ギャラリー・サマー・パビリオン」を歴代最年少で設計。同年、マークス建築賞受賞。2012年、第13回ベネチア・ビエンナーレ国際建築展日本館の展示で金獅子賞を協同受賞。

Fujimoto identified an interesting issue: how can we think of architecture for dogs existing beyond the confines of architecture for humans, adding that dogs are by their very nature “natural,” so it would be interesting to see how they dealt with an unexpected yet “natural” setting. This was precisely the clutch motive in this piece. Dogs would not even approach the original spherical plan.

犬の建築は人の建築の内部にあるという点が難しいと、藤本壮介は語っていた。また、犬は「自然」そのものであり、思い通りにならない自然にどう向き合うかが大事だとも語っていた。いずれも本プロジェクトの要点である。当初の球体プランに犬は見向きもせず、ジャングルジムのような建築はその代替案であった。「サーペントイン・ギャラリー」の建築はここから生まれた。



P : Hiroshi YODA





Concept of Design | Sou FUJIMOTO

This is the house where the dog lives, placed within the house where the people live. This architecture is a living space for the dog, as well as furniture for the people, a garden within the house, as well as a gentle boundary between the people and the dog. Our plan offers a house in which can be combined many different things that arise in the humans' and dog's living space, architecture for a space that holds a new abundance. We've taken small (7mm) square panels of hinoki [Japanese cypress] to make a grid pattern in which each square is 200mm, to which we've attached 2mm-thick transparent acrylic board, in essence creating a structure that looks like a 800mm-cubed shelf. The hollowed out interior section of this lattice functions as the dog's residence, while on top of the clear shelf are stored various things for either dog or humans: a collar; a dish; books; a plant.... This scenery, in which various things relating to daily life surround the dog, overflows with chances for the dog to proactively get involved in that daily life, and projects a new relationship between humans and dogs. Humans artificially turned dogs into pets. Dogs, as pets, therefore lose their animal understanding. NO DOG, NO LIFE! is a new architectural space meant to act as a framework within which humans and dogs can, as they live together, interact proactively.

作品解説 | 藤本壮介

人間の生活する家の中に置かれた、犬の生活する家。この建築は、犬のための生活空間であり、人間のための家具であり、家の中の庭であり、人間と犬との間の柔らかな境界である。私たちの提案は、人間と犬の生活空間に生まれるさまざまな物事を含み込むことのできる家、新しい豊かさを持った、間の建築です。形状は、7mm角のヒノキ材を200mmグリッドの格子状に組み、その上に2mm厚の透明の亚克力板を設置した、800mmキューブの棚のようになっています。この格子の内側を剥り抜いた部分に犬の居住空間を用意し、透明な棚の上には首輪や皿や本や植物といった、人間と犬のさまざまなものが収納されます。生活にまつわるさまざまなものが犬を取り巻く風景は、犬自身が主体的に生活に関わるきっかけに溢れた、人間と犬の新しい関係性を映し出しています。ペットとしての犬を人工的に作り出した人間、ペットゆえに動物としての意思を失ってしまった犬。「NO DOG, NO LIFE!」は、人間と犬自身が、生活する中で主体的に相互へ働きかける枠組みとなるような、人間と犬のための新しい建築空間です。



Process | 制作過程



This was the initial design proposal. Fujimoto wanted to create a spherical architecture for the Boston Terrier, so fond of playing with round balls. However when testing the structure in real life, we found the dogs were unsure of themselves and found it difficult to walk into a spherical structure. They did not recognize the structure as a space to enter.

最初に提案された案。
ボールと触れ合うことが大好きなボストンテリアのための、
ボールのように丸い建築である。
しかし実際に犬に使わせてみたところ、
不安定な球体の中に入るのが難しく、
犬はそこを「居場所」だと認識しなかった。

The redesign. This is close to the final realization of our design, but the exterior still looked like a traditional dog house.

再提案された案。最終案にかなり近いが、
外観はまだ典型的な犬小屋の形をしている。



Mockup of the final design. In order to balance the difficulty of the completed design, we calculated the dog-friendliness of materials to within millimeters, with several test builds.

最終案のモックアップ。全体イメージと作品強度のバランスを取るため、
材の太さを数mm単位で検証し、何度も試作を繰り返した。

Component Pieces :

Frame

Cypress 7mm squared · L900mm

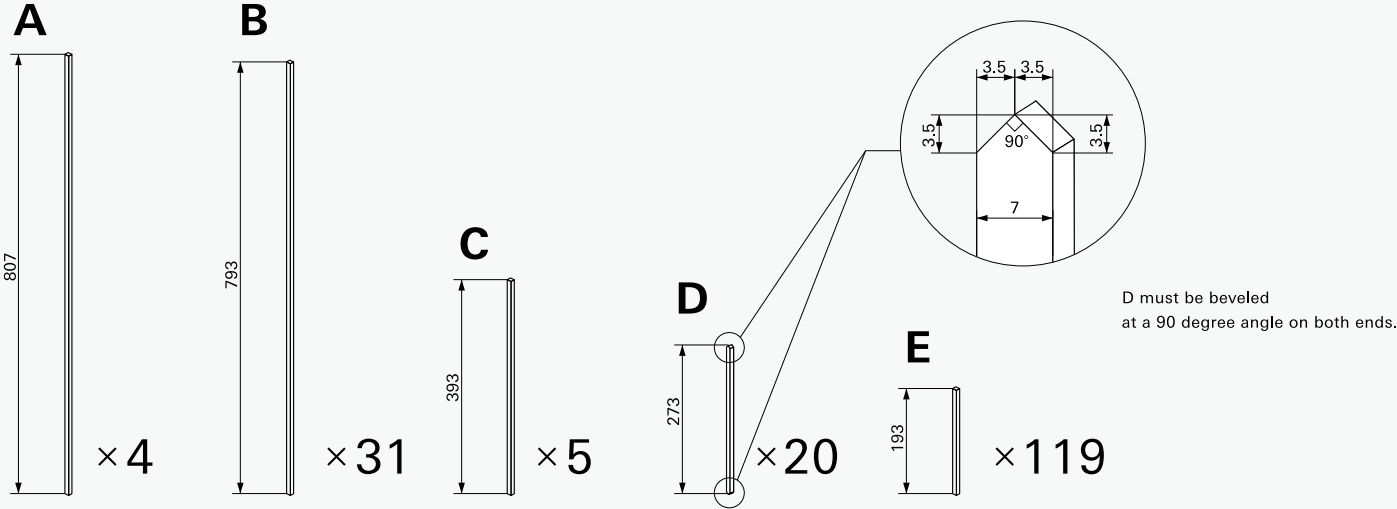

Shelves

Acrylic sheets t=2mm

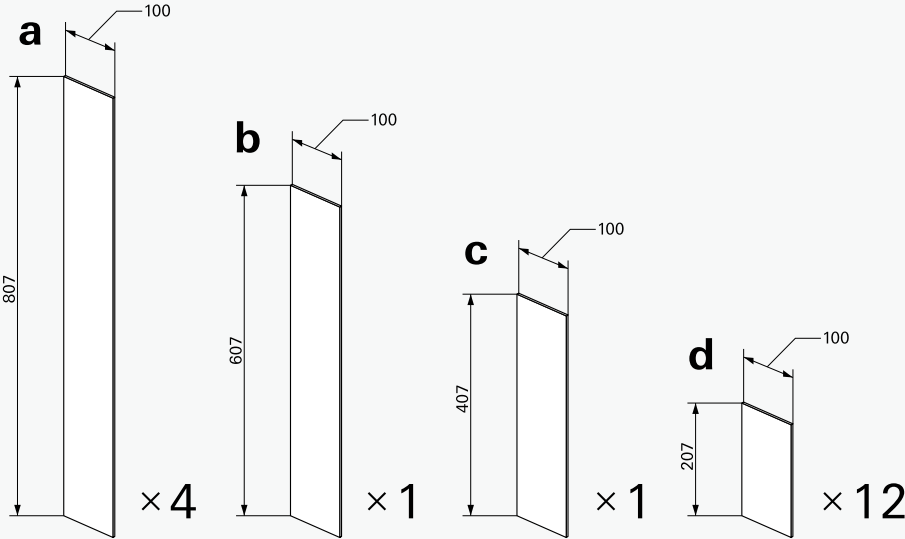

Materials :

- Cypress 7mm squared / L900mm 73 pieces
- Acrylic Sheets / t=2mm
- Wood Glue
- Pin Tacks or Thin Nails
- Varnish or Clear Coat
- Transparent Double-sided Tape

Tools :

- Saw
- Ruler
- Pin Tacks
- Paintbrush

Size :

w800 × d800 × h800 mm

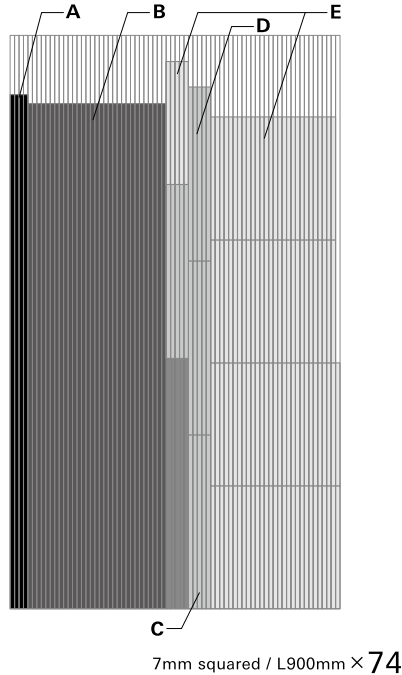

This is a construction project and is not advisable for children under the age of 13, unless under the supervision of adults. Please use caution when using cutting tools, and wear eye and hand protection at all times. All measurements are in metric units and our list of wood materials, only suggestions.

Architecture for Dogs is not responsible for any injuries incurred from the building process or derived from the structure itself, nor does it take responsibility for faulty materials or unsatisfactory results.

(c) Architecture for Dogs, 2012. All Rights reserved. The download of this blueprint in no way transfers any copyright or other ownership interest in them to the buyer except for a limited license to use it to construct one piece at a time.

Assembly Instructions :

1

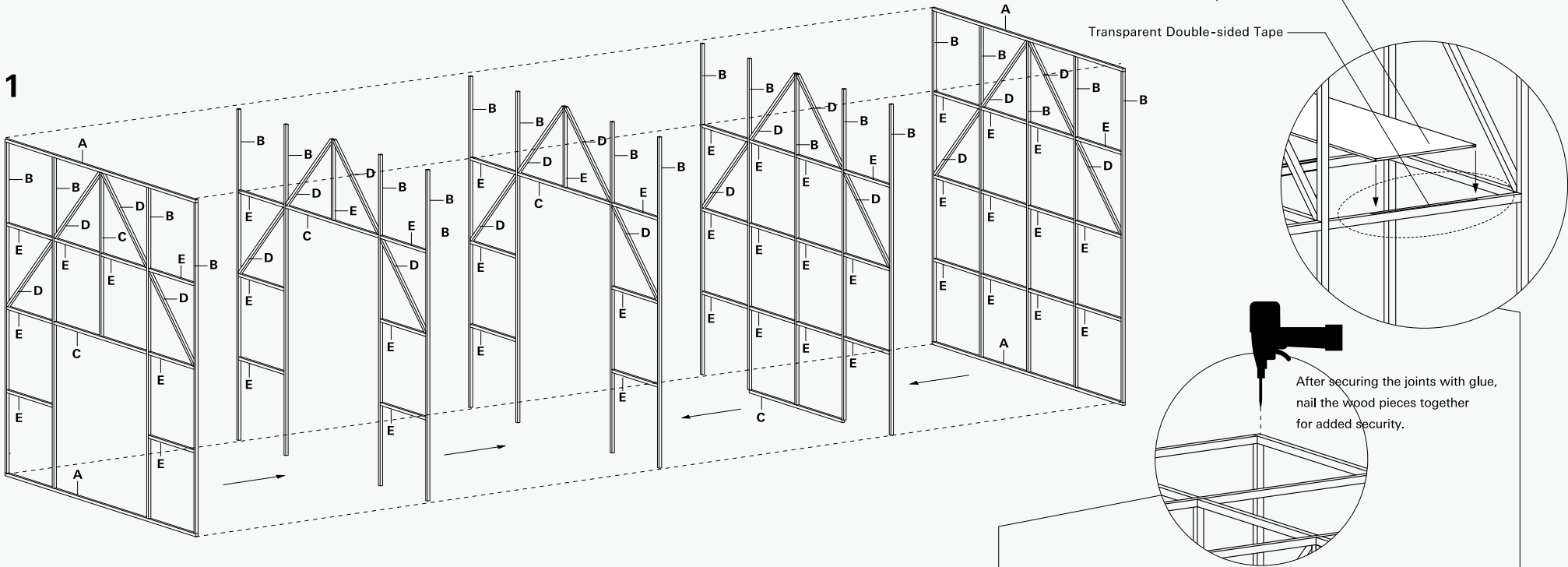

2 B × 9

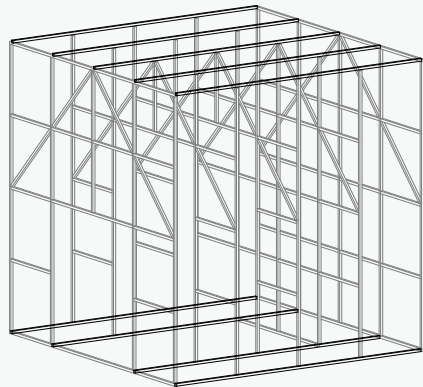

3 E × 55

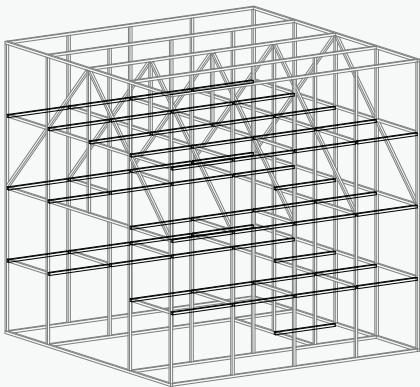

4 E × 18

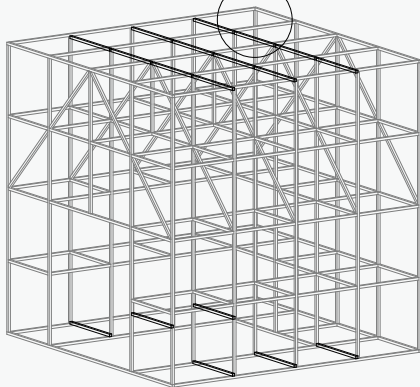

5 a/b/c/d

